

Map 1

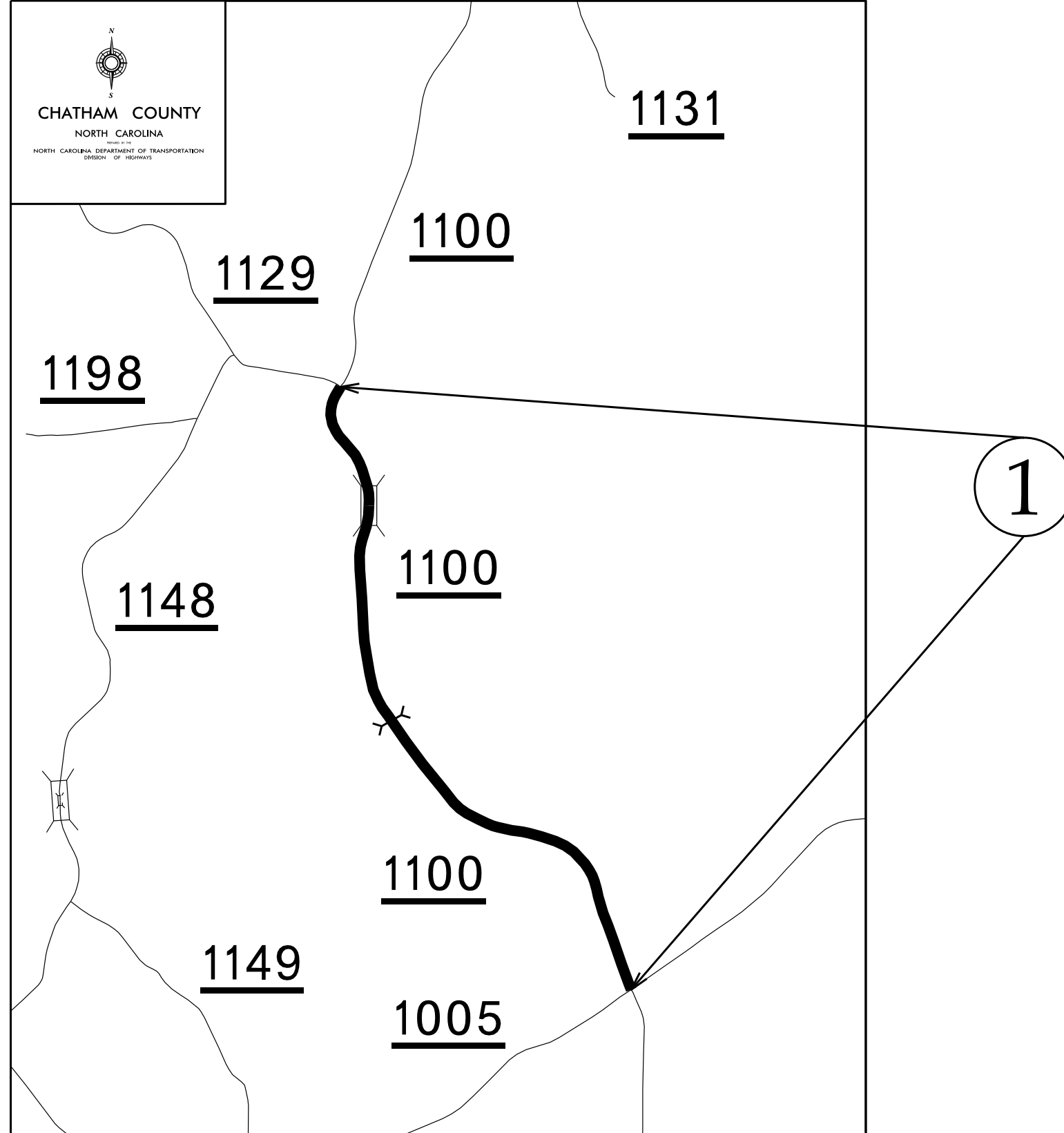

Map 2

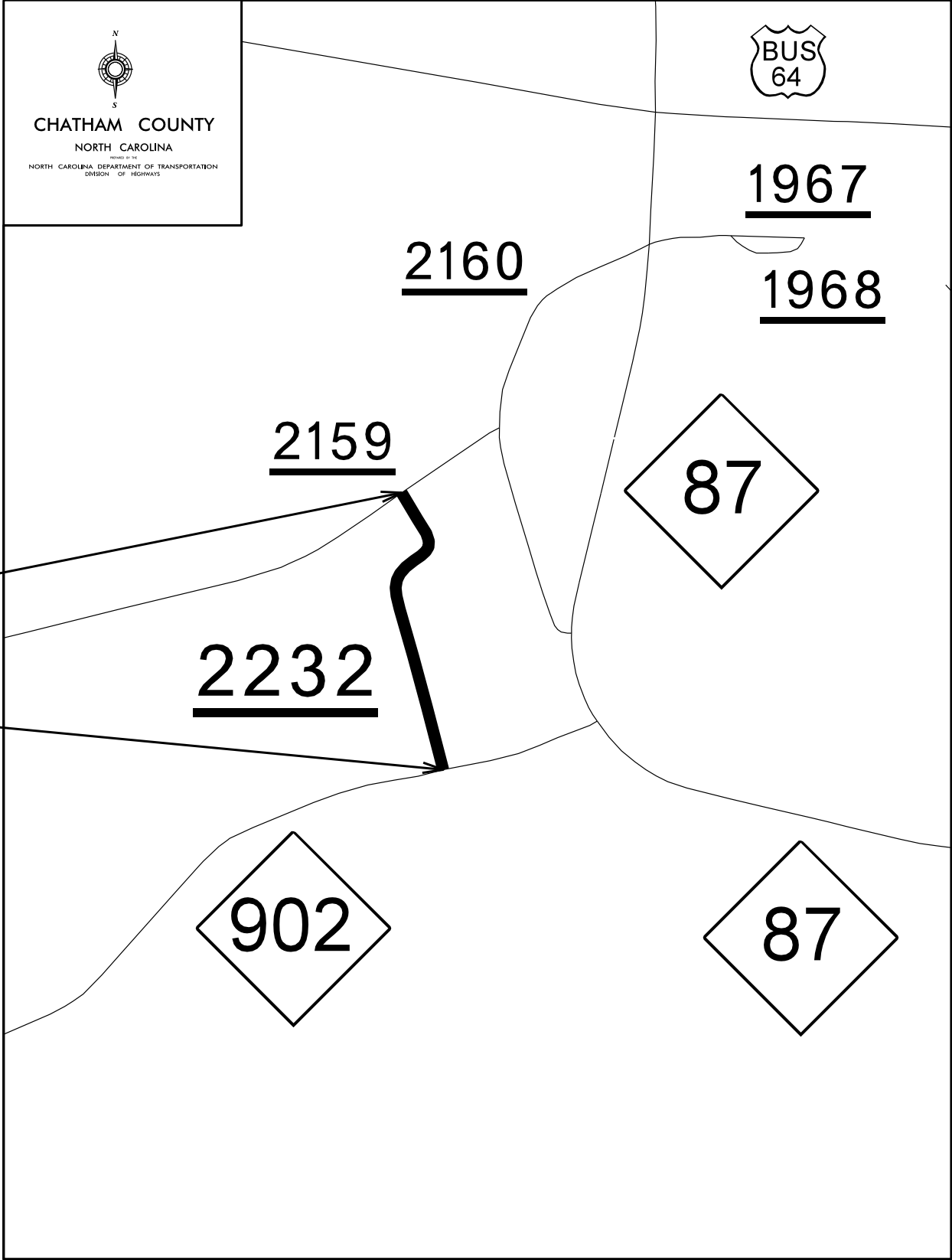

Map 3

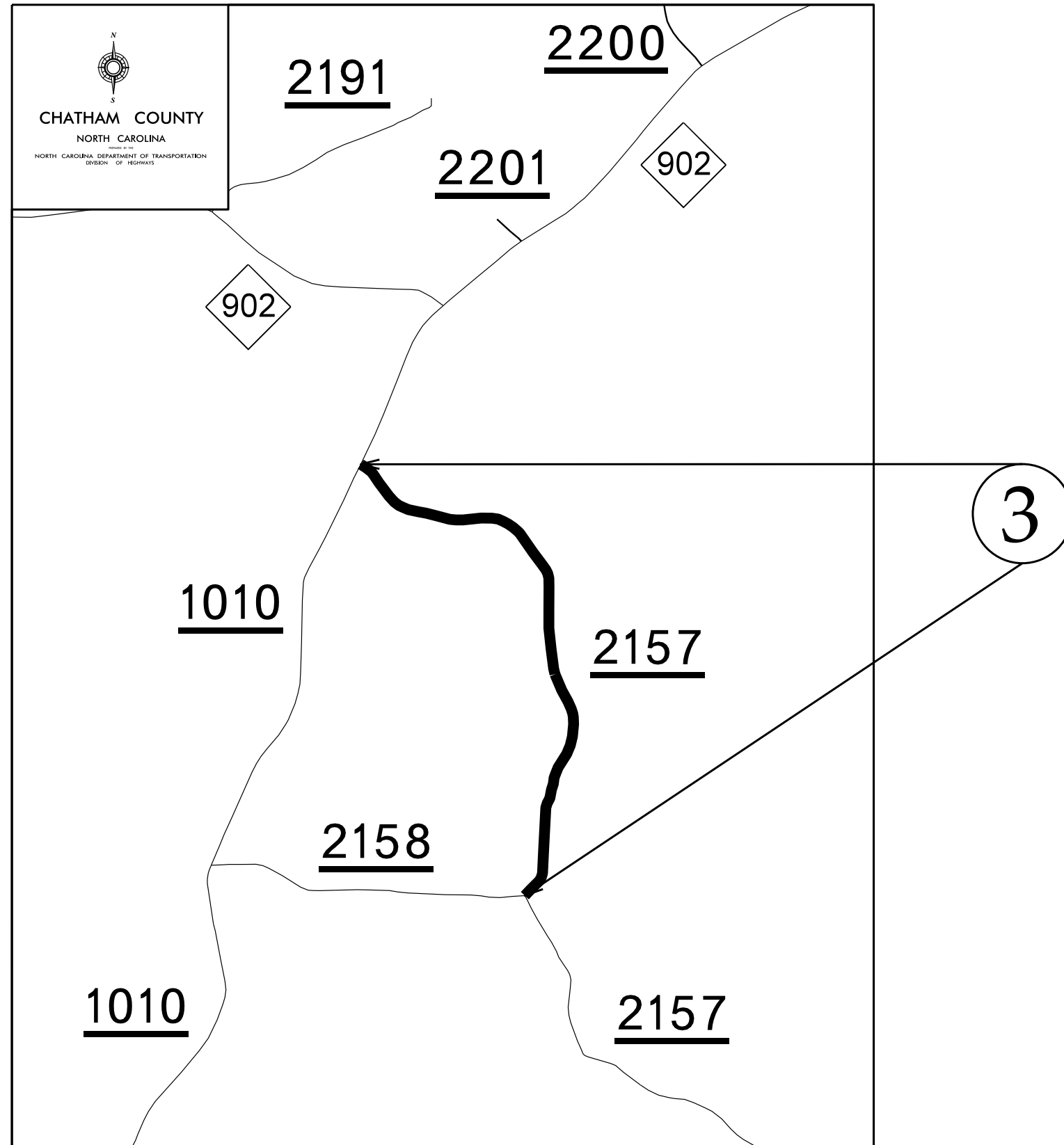

Map 4

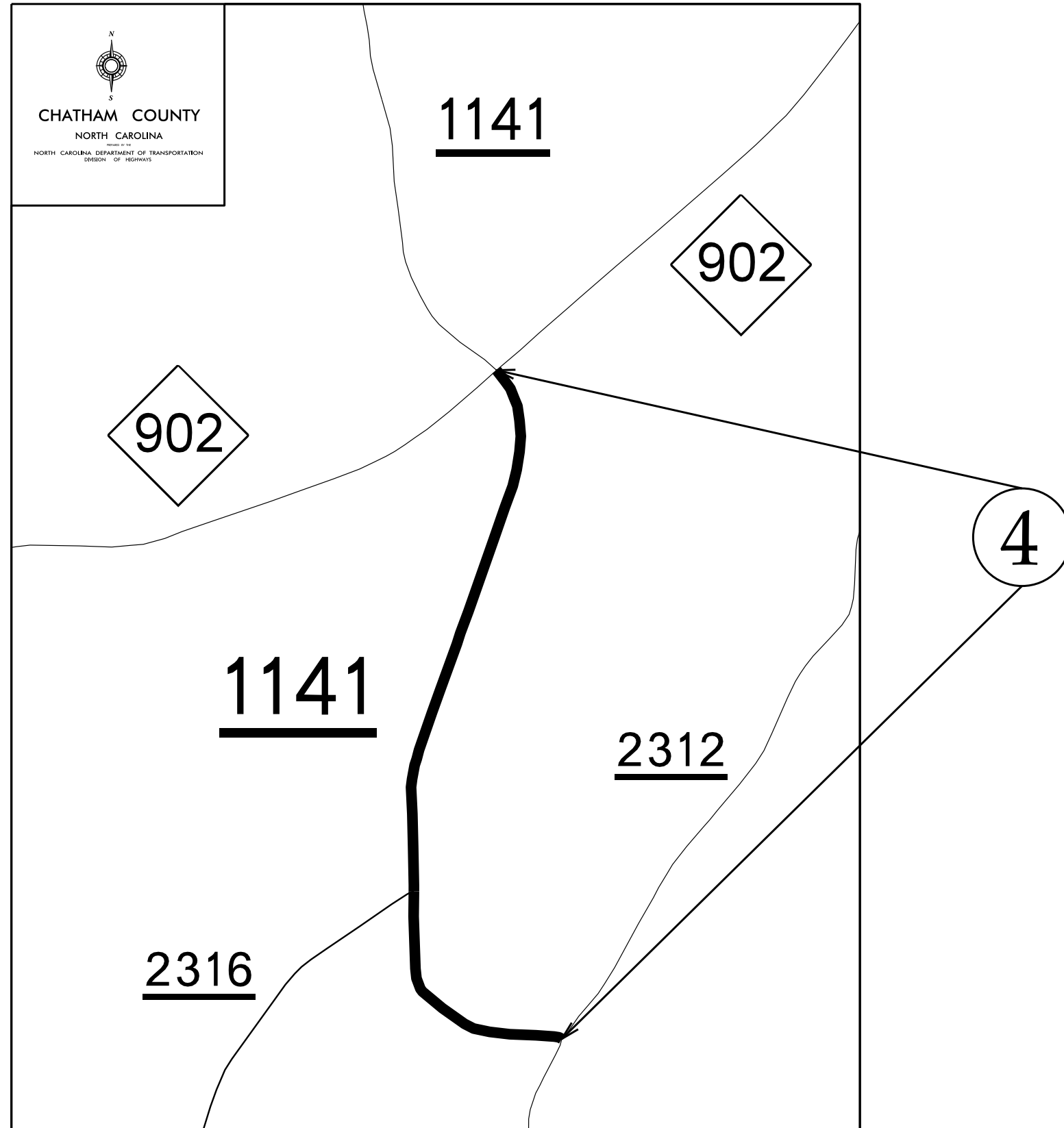

Map 5

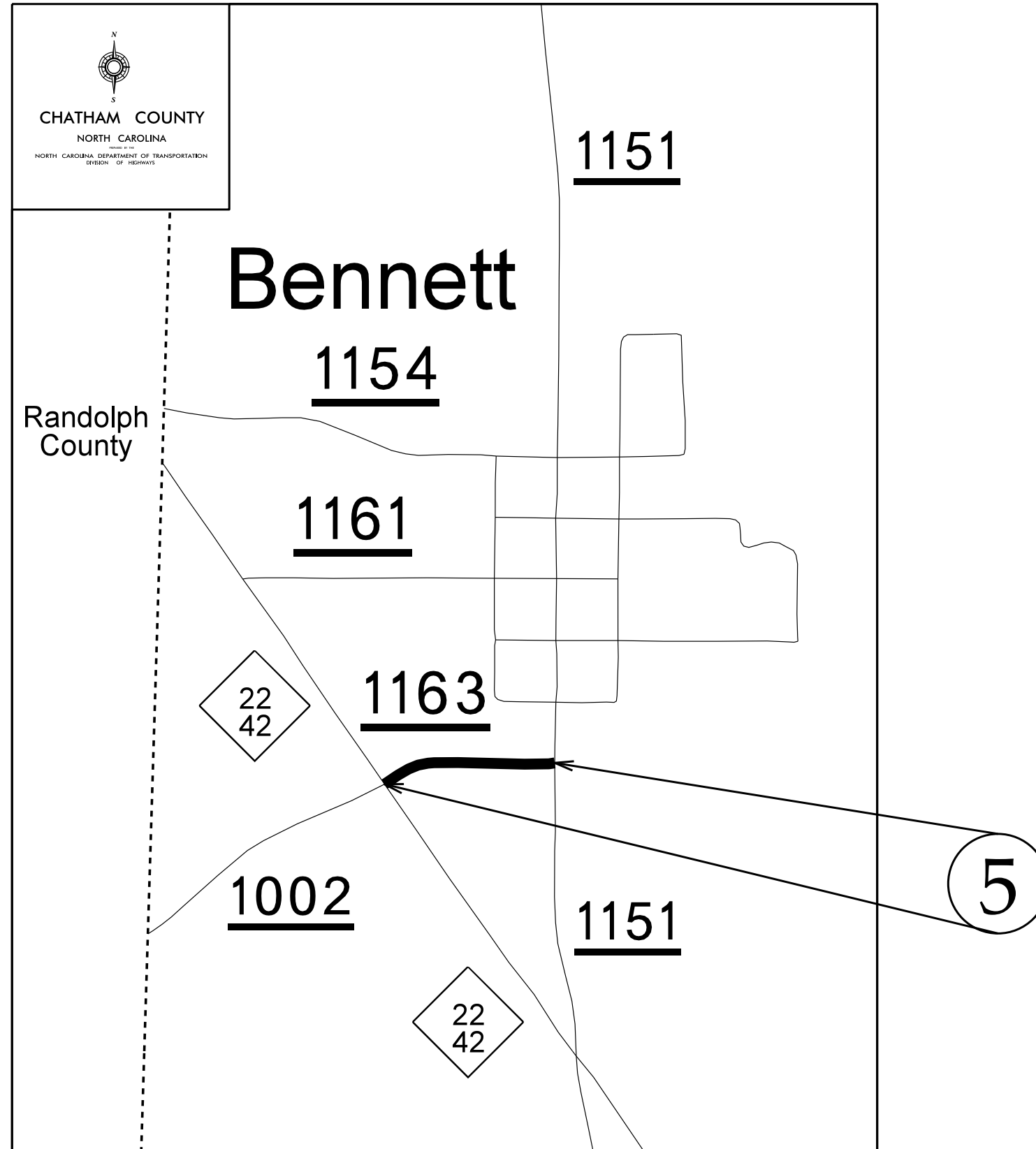

Map 6

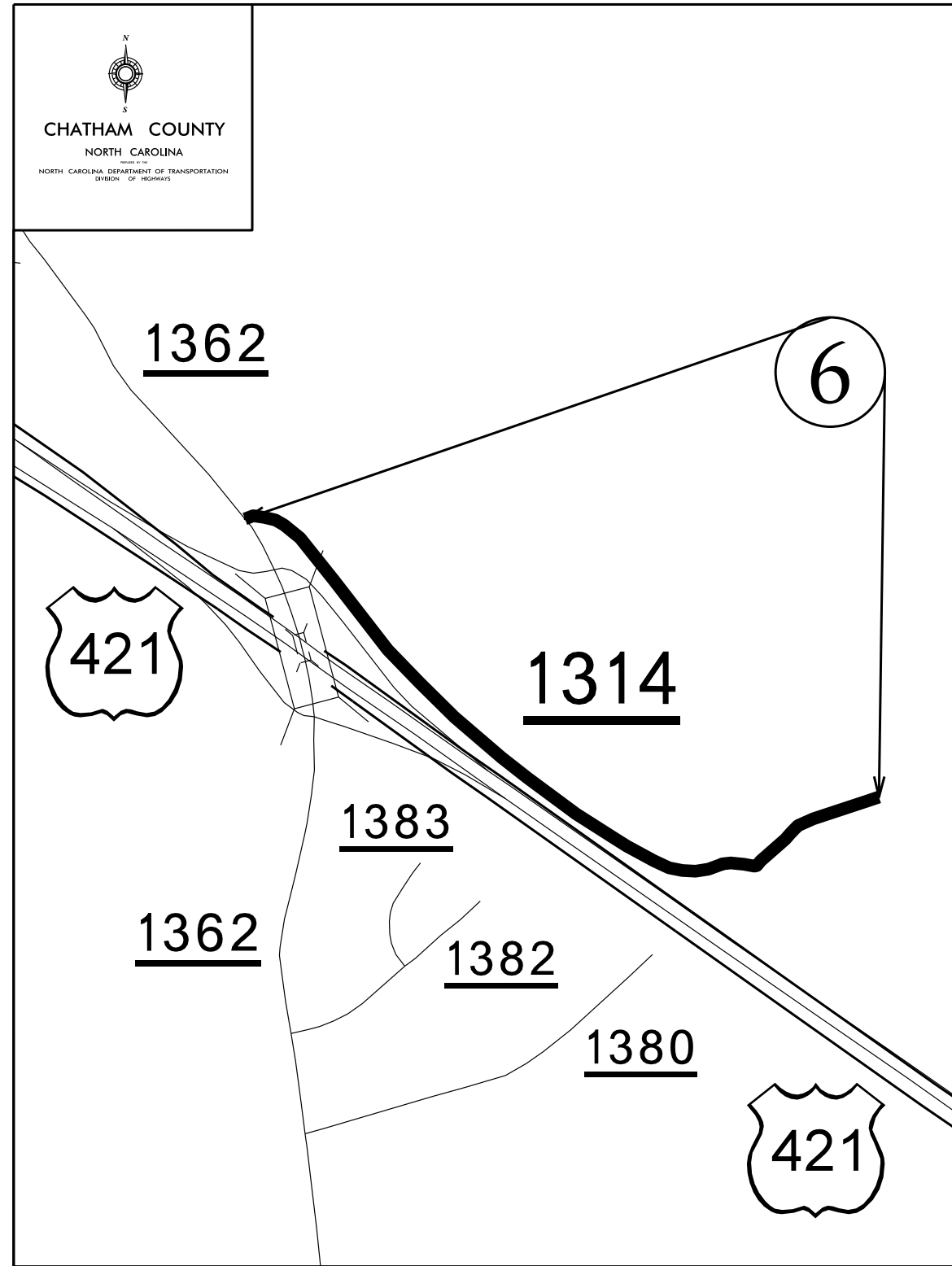

Map 7

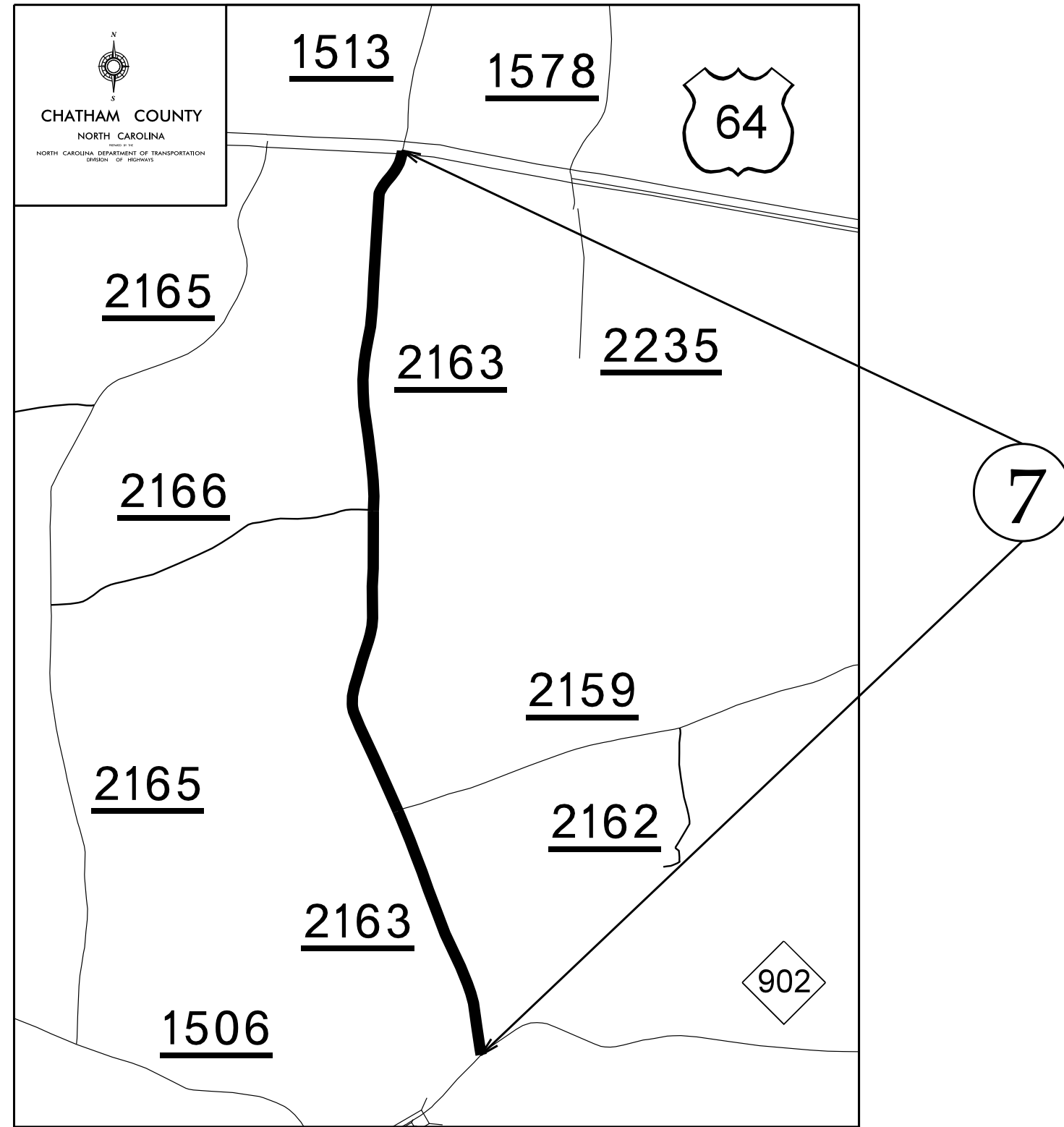

Map 8

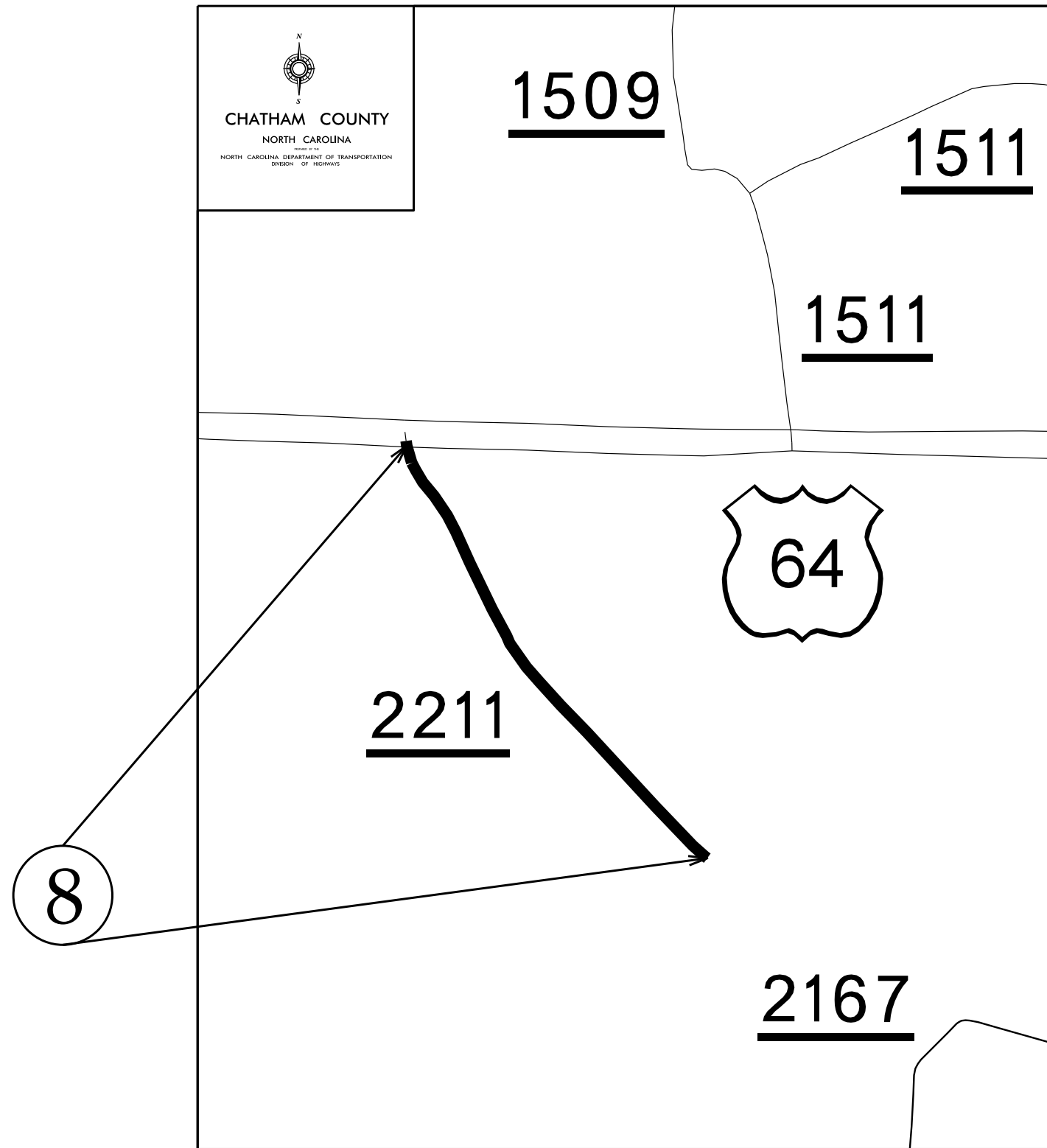

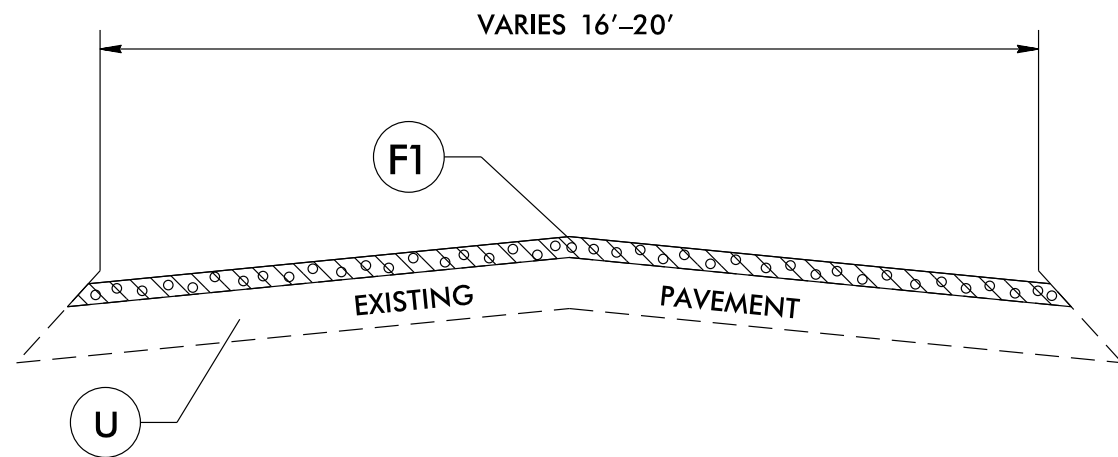

TYPICAL SECTION NO.1

PAVEMENT SCHEDULE	
F1	PROP. ASPHALT SURFACE TREATMENT DOUBLE SEAL
U	EXISTING PAVEMENT

PROJECT NO.	SHEET NO.	TOTAL NO.
2024CPT.08.16.20192	11	

SUMMARY OF QUANTITIES

PROJECT NO	COUNTY	MAP NO	ROUTE	DESCRIPTION	TYP NO	LANES	LANE TYPE	FINAL SURFACE TESTING REQUIRED	WARM MIX ASPHALT REQUIRED	LENGTH	WIDTH	BEGIN MP	END MP	1803500000-E	1838000000-E	1838500000-N
														ASPHALT SURFACE TREATMENT, DOUBLE SEAL	EMULSION FOR ASPHALT SURFACE TREATMENT	VACUUM TRUCK
														SY	GAL	WK
2024CPT.08.16.20192	Chatham	1	SR-1100 / AIRPORT RD	FROM SR 1005 (BONLEE BENNETT RD) TO SR 1129 (LAMBERT CHAPEL RD)	1	2	2WU	NO	NO	2.32	20	5.11	7.43	27,200.00	15,000	*
TOTAL FOR MAP NO. 1										2.32				27,200.00	15,000	
2024CPT.08.16.20192	Chatham	2	SR-2232 / WOODBERRY FOREST	FROM SR 2159 (ALSTON CHAPEL RD) TO NC 902	1	2	2WU	NO	NO	0.42	20	0	0.42	5,000.00	2,800	
TOTAL FOR MAP NO. 2										0.42				5,000.00	2,800	
2024CPT.08.16.20192	Chatham	3	SR-2157 / PETE ROBERSON RD	FROM SR 1010 (PITTSBORO GOLDSTON RD) TO SR 2158 (HOLLY RIDGE RD)	1	2	2WU	NO	NO	1.8	20	0	1.8	21,200.00	11,700	
TOTAL FOR MAP NO. 3										1.8				21,200.00	11,700	
2024CPT.08.16.20192	Chatham	4	SR-1141 / TOM HANCOCK RD	FROM SR 2312 (VANDER OLDHAM RD) TO NC 902	1	2	2WU	NO	NO	1.51	20	0	1.51	17,800.00	9,800	
TOTAL FOR MAP NO. 4										1.51				17,800.00	9,800	
2024CPT.08.16.20192	Chatham	5	SR-1163 / WASHINGTON ST	FROM NC 22 TO SR 1151 (BONLEE BENNETT RD)	1	2	2WU	NO	NO	0.26	20	0	0.26	3,100.00	1,700	
TOTAL FOR MAP NO. 5										0.26				3,100.00	1,700	
2024CPT.08.16.20192	Chatham	6	SR-1314 / WATER PLANT RD	FROM SR 1362 (PINEY GROVE CHURCH RD) TO END MAINT.	1	2	2WU	NO	NO	1.08	21	0	1.08	13,400.00	7,400	
TOTAL FOR MAP NO. 6										1.08				13,400.00	7,400	
2024CPT.08.16.20192	Chatham	7	SR-2163 / ALEX COCKMAN RD	FROM US 64 TO NC 902	1	2	2WU	NO	NO	2.99	20	0	2.99	35,100.00	19,300	
TOTAL FOR MAP NO. 7										2.99				35,100.00	19,300	
2024CPT.08.16.20192	Chatham	8	SR-2211 / DAVE MCCRACKEN RD	FROM US 64 TO END MAINT.	1	2	2WU	NO	NO	0.79	20	0	0.79	9,300.00	5,100	
TOTAL FOR MAP NO. 8										0.79				9,300.00	5,100	
TOTAL FOR PROJ NO. 2024CPT.08.16.20192										11.17				132,100.00	72,800	7.00
GRAND TOTAL										11.17				132,100.00	72,800	7.00

PROJECT NO.	SHEET NO.	TOTAL NO.
2024CPT.08.16.20192	12	

THERMOPLASTIC AND PAINT QUANTITIES

PROJECT NO	COUNTY	MAP NO	ROUTE	DESCRIPTION	TYP NO	LANES	LANE TYPE	LENGTH	WIDTH	BEGIN MP	END MP	4413000000-E	4457000000-N	4815000000-E		4835000000-E
								MI	FT			WORK ZONE ADVANCE/GENERAL WARNING SIGNING	TEMPORARY TRAFFIC CONTROL	6" YELLOW PAINT	6" WHITE PAINT	24" WHITE PAINT
												SF	LS	LF	LF	LF
2024CPT.08.16.20192	Chatham	1	SR-1100 / AIRPORT RD	FROM SR 1005 (BONLEE BENNETT RD) TO SR 1129 (LAMBERT CHAPEL RD)	1	2	2WU	2.32	20	5.11	7.43	260		24,963	24,963	
TOTAL FOR MAP NO. 1								2.32				260		24,963	24,963	
2024CPT.08.16.20192	Chatham	2	SR-2232 / WOODBERRY FOREST	FROM SR 2159 (ALSTON CHAPEL RD) TO NC 902	1	2	2WU	0.42	20	0	0.42	50				
TOTAL FOR MAP NO. 2								0.42				50				
2024CPT.08.16.20192	Chatham	3	SR-2157 / PETE ROBERSON RD	FROM SR 1010 (PITTSBORO GOLDSTON RD) TO SR 2158 (HOLLY RIDGE RD)	1	2	2WU	1.8	20	0	1.8	210		19,368	19,368	
TOTAL FOR MAP NO. 3								1.8				210		19,368	19,368	
2024CPT.08.16.20192	Chatham	4	SR-1141 / TOM HANCOCK RD	FROM SR 2312 (VANDER OLDHAM RD) TO NC 902	1	2	2WU	1.51	20	0	1.51	170		16,248	16,248	
TOTAL FOR MAP NO. 4								1.51				170		16,248	16,248	
2024CPT.08.16.20192	Chatham	5	SR-1163 / WASHINGTON ST	FROM NC 22 TO SR 1151 (BONLEE BENNETT RD)	1	2	2WU	0.26	20	0	0.26	30		2,798	2,798	
TOTAL FOR MAP NO. 5								0.26				30		2,798	2,798	
2024CPT.08.16.20192	Chatham	6	SR-1314 / WATER PLANT RD	FROM SR 1362 (PINEY GROVE CHURCH RD) TO END MAINT.	1	2	2WU	1.08	21	0	1.08	130		11,621	11,621	
TOTAL FOR MAP NO. 6								1.08				130		11,621	11,621	
2024CPT.08.16.20192	Chatham	7	SR-2163 / ALEX COCKMAN RD	FROM US 64 TO NC 902	1	2	2WU	2.99	20	0	2.99	340		32,172	32,172	30
TOTAL FOR MAP NO. 7								2.99				340		32,172	32,172	30
2024CPT.08.16.20192	Chatham	8	SR-2211 / DAVE MCCRACKEN RD	FROM US 64 TO END MAINT.	1	2	2WU	0.79	20	0	0.79	90		8,500	8,500	35
TOTAL FOR MAP NO. 8								0.79				90		8,500	8,500	35
TOTAL FOR PROJ NO. 2024CPT.08.16.20192								11.17				1,280	1	115,670	115,670	65
												231,340				
GRAND TOTAL								11.17				1,280	1	115,670	115,670	65
												231,340				

SIGNING FOR ASPHALT SURFACE TREATMENT

LEGEND

- ◻ PORTABLE SIGN
- └ STATIONARY SIGN
- ← DIRECTION OF TRAFFIC FLOW

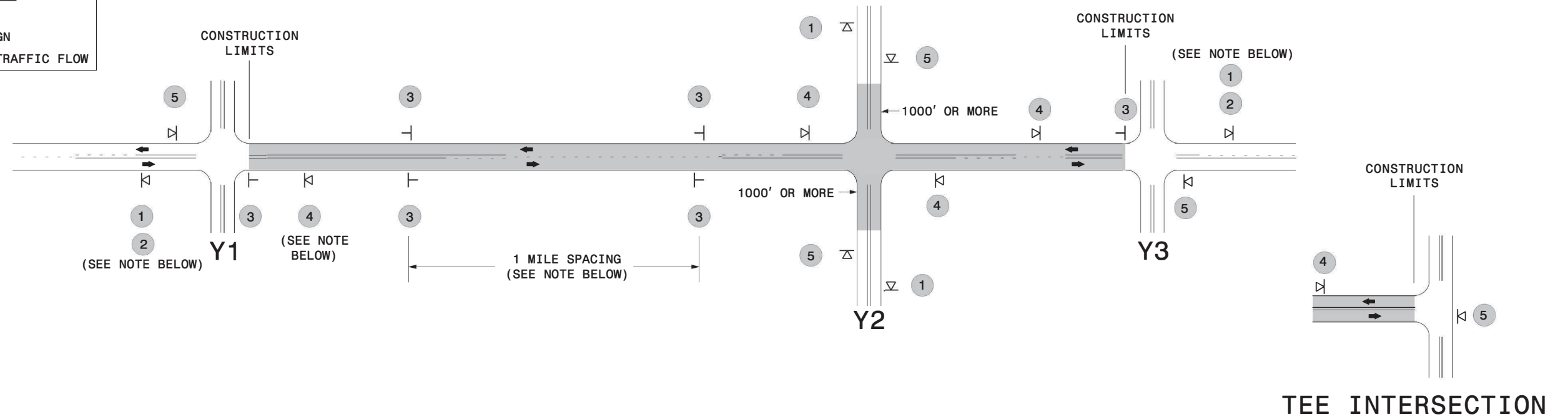

MAINLINE (-L-) SIGNING

-Y- LINE SIGNING

SIGNING NOTES AND PLACEMENT PER DIRECTION	1		- PLACE 1000' PRIOR TO BEGINNING OF CONSTRUCTION LIMITS. ONLY USED ON -Y- LINES IF RESURFACING LIMITS EXTEND 1000' ALONG -Y- LINE.	<p>STATIONARY SIGNING NOT REQUIRED FOR THE FOLLOWING -Y- LINE CONDITIONS:</p> <ol style="list-style-type: none"> 1) LESS THAN 1000' OF RESURFACING ALONG -Y- LINE 2) SUBDIVISION ROADS 3) DEAD END ROADS <p>WHEN PAVING/CONSTRUCTION ACTIVITIES PROCEED ACROSS AN UNSIGNED -Y- LINE, PORTABLE ADVANCE WARNING SIGNS SHALL BE USED ALONG THE -Y- LINE AS SHOWN BELOW. REMOVE UPON COMPLETION OF WORK.</p> <div style="display: flex; justify-content: space-around;"> <div style="text-align: center;"> W20-1 48" X 48" PLACED 500' IN ADVANCE OF FLAGGER. </div> <div style="text-align: center;"> W20-7 A 48" X 48" PLACED 250' IN ADVANCE OF FLAGGER. </div> </div>
	2		- SIGN #2 ONLY USED WHEN RESURFACING LIMITS ARE 2 OR MORE MILES IN LENGTH. ROUND UP TO THE NEAREST WHOLE NUMBER. DO NOT USE FRACTIONAL OR DECIMAL NUMBERS.	
	3	 	- ALTERNATE THE FOLLOWING TWO SIGNS: - STARTING WITH "LOOSE GRAVEL" (W8-7) FOLLOWED BY "UNMARKED PAVEMENT". - PLACE INITIALLY AT THE CONSTRUCTION LIMITS AND SPACED 1 MILE APART THEREAFTER. - AT TEE INTERSECTIONS INSTALL INITIALLY 0.5 MILE FROM INTERSECTION AND SPACE 1 MILE APART THEREAFTER.	
	4		- THESE ARE FOR -Y- LINES THAT ARE "THROUGH" ROADWAYS. DEAD END AND SUBDIVISION ROADS ARE NOT "THROUGH" ROADWAYS. - INSTALL 500' +/- FROM EACH -Y- LINE APPROACH AS SHOWN ABOVE. - FOR MULTIPLE -Y- LINES THAT ARE SEPARATED BY 0.25 MILES OR LESS, TREAT AS A SINGLE UNIT AND INSTALL WITHIN 500' OF EACH APPROACH. - A MAXIMUM OF 2 SIGN SETS PER MILE. DO NOT INSTALL WHEN -Y- LINES ARE WITHIN 0.5 MILES FROM "END ROAD WORK" SIGN.	
	5		PLACE 500' FOLLOWING THE END OF CONSTRUCTION LIMITS OR AS SHOWN WHEN WORK ENDS AT A 3-WAY TEE INTERSECTION.	

THE ABOVE SIGNS ARE ALL THAT ARE REQUIRED FOR A CONTRACTOR TO BEGIN A RESURFACING CONTRACT. ANY ADDITIONAL SIGNS REQUESTED BY NCDOT DIVISIONS SHALL BE INSTALLED WITHIN 7 BUSINESS DAYS OF THE START OF CONTRACT WORK.

MAPS LESS THAN 2 MILES

FOR AST RESURFACING MAPS WITH CONSTRUCTION LIMITS LESS THAN 2 MILES IN LENGTH, USE A STATIONARY "LOOSE GRAVEL" SIGN AT THE BEGINNING CONSTRUCTION LIMIT FOLLOWED BY AN "UNMARKED PAVEMENT" SIGN MIDWAY THROUGH AND AN "END ROAD WORK" SIGN AT THE END CONSTRUCTION LIMIT.



ADVANCE WARNING SIGNS FOR 2-LANE ROADWAY ASPHALT SURFACE TREATMENT